

The Heartland and Karoo Research Institute

CC Reg: 2004/072194/23

7 Colin Fraser Street
PO Box 139
Philippolis 9970
Free State Province
South Africa

Tel (27)(51) 7730324
Cell 083 274 5461
E-mail: doreen@karoofoundation.co.za

www.philippolislegacy.com

Philippolis Legacy Project:

Leonardus Bohnen (senior and junior)

Prof Doreen Atkinson

CONTENTS

A.	Leonardus Bohnen	3
B.	Town erven	3
1.	The Philippolis Hotel	3
2.	The Du Toit home and Labomat Engineering	4
3.	Erf 170	5
4.	Malherbe Plein and Philippolis Library	5
5.	Foodzone	8
C.	Farm purchases	9
6.	Farm "Geluk" and "Annex Geluk"	9
7.	Farm "Tuinplaats"	13
8.	Farm "Smaldeel"	15
9.	Farm "Middenpost" and "Annex Middenpost"	17
10.	Farm "Annex Eben"	20
11.	"Vechtkop"	22
C.	Waterkloof village (5 km south of Philippolis)	24
D.	Bohnens serving the NG Church in Philippolis	25
E.	Marriage certificate	25
F.	Bohnens in the concentration camps 1900-1902	26
1.	Bethulie (and later Uitenhage)	26
2.	Norvalspont	27

G. The Bohnens' economic life after the war.....	27
Appendix: Title Deeds Data.....	29
1. The Philippolis Hotel:.....	29
2. The Du Toits' home and Labomat Engineering site.....	29
3. Malherbe Plein and Municipal Library	30
4. Erf 170:.....	31
5. Geluk:.....	31
6. Annex Geluk:.....	32
7. Tuinplaats:	32
8. Smaldeel:	34
9. Middenpost:	34
10. Annex Eben	35
11. Vechtkop.....	36

A. Leonardus Bohnen

Our information refers to two individuals: Leonardus Bohnen (senior) and Leonardus Bohnen (junior). It is not always entirely clear which person is referred to in the data.

B. Town erven

This data is drawn from the Free State Title Deeds holdings, and are presented roughly in chronological order:

1. The Philippolis Hotel

Date	Erven	Transactions	Current address
1886	32, 33 and 34	Bohnen was the first owner of the site. It is not clear whether LB used it as a hotel (we should find this out in due course). Bohnen owned the site for about 7 years, and then sold it to Charles Edmondson in 1893.	Philippolis Lodge hotel GPS 30°15'57.5"S 25°16'27.6"E ¹

The modern-day Philippolis Lodge Hotel:



¹ Click here: <https://www.google.com/maps/place/30%C2%B015'57.5%22S+25%C2%B016'27.6%22E/@-30.26596,25.2732265,330m/data=!3m2!1e3!4b1!4m14!1m7!3m6!1s0x1e85c27248dc6e2f:0x4018a5b77bc2430!2sPhilippolis,+9970!3b1!8m2!3d-30.2514772!4d25.2719048!3m5!1s0x0:0x0!7e2!8m2!3d-30.2659596!4d25.274335>

2. The Du Toit home and Labomat Engineering

Date	Erven	Transactions	Current address
1892	188	Bohnen purchased this erf in 1892. This is in the middle area of Voortrekker Street, on the east side of the street, almost exactly opposite the hotel. James Derbyshire. He sold it in 1903 to Philippus Snyman.	This erf is now part of the Du Toit home (59 Voortrekker Street) GPS 30°15'54.3"S 25°16'27.9"E ²
1896	189	Four years after purchasing Erf 188, Bohnen expanded this site further southwards, by purchasing 189. He seems to have been the original owner of the site. He sold it in 1903 to Philippus Snyman.	Now part of Labomat Engineering works (63 Voortrekker Street) GPS -30.265519, 25.274634 ³
1898	187	Two years after purchasing Erf 189, Bohnen expanded his holdings northwards, to include site 187. He purchased the erf from the OFS Government. He sold it in 1903 to Philippus Snyman.	This erf is now part of the Du Toit home

The Du Toit home:



² Click here: <https://www.google.com/maps/place/30%C2%B015'54.3%22S+25%C2%B016'27.9%22E/@-30.265083,25.2733256,327m/data=!3m2!1e3!4b1!4m14!1m7!3m6!1s0x1e85c27248dc6e2f:0x4018a5b77bc2430!2sPhilippolis,+9970!3b1!8m2!3d-30.2514772!4d25.2719048!3m5!1s0x0:0x0!7e2!8m2!3d-30.2650831!4d25.2744257>

³ Click here: <https://www.google.com/maps/place/30%C2%B015'55.9%22S+25%C2%B016'28.7%22E/@-30.265519,25.2724453,651m/data=!3m2!1e3!4b1!4m6!3m5!1s0x0:0x0!7e2!8m2!3d-30.2655195!4d25.2746336>

Labomat Engineering Works (63 Voortrekker Street):



3. *Erf 170*

Date	Erven	Transactions	Current address
1886	170	Bohnen was the original owner. He sold it in 1906 to the local trader, Gerrit Sem	This house is on the west side of Voortrekker street, just a few erven south of the Hotel. GPS 30°16'00.9"S 25°16'28.8"E



4. *Malherbe Plein and Philippolis Library*

After the Anglo-Boer War, Leonardus Bohnen purchased some erven further north in Voortrekker Street. One of them is the well-known Philippolis Library building.

Date	Erven	Transactions	Current address
1904	10	Purchased from the OFS Government in 1904	Malherbe Plein, Voortrekker Street GPS: -30.262280, 25.273059 ⁴
1903	11	Purchased from Dr Otto Krause, the well-known Free State doctor	Malherbe Plein, Voortrekker Streer
1904	12	Purchased from Jemima Cornelia Visser	The Philippolis Library GPS : 30°15'44.2"S 25°16'23.0"E

During the 1940s, the site was the Pegasus Garage, owned by Mr Botes. (This is the building to the left of the double-story building).



The Nienaber Plein is an important site, because the historic Griqua cannons are perched on the hill above it.

The Plein today, showing one of the cannons on the top of the hill behind the square:

⁴ Click here: <https://www.google.com/maps/place/30%C2%B015'44.2%22S+25%C2%B016'23.0%22E/@-30.26228,25.2719676,325m/data=!3m2!1e3!4b1!4m6!3m5!1s0x0:0x0!7e2!8m2!3d-30.2622802!4d25.2730586>



The Library:



5. Foodzone

At roughly the same time, Bohnen purchased this landmark site:

Date	Erven	Transactions	Current address
1903	22	Purchased from Philippus Snyman	<p>This is now Foodzone. Many people still remember the shop as “Ons Dien”, which was its name for many decades.</p> <p>It is possible that this was the site used by Emily Hobhouse for her weaving school, around 1903. Once I confirm this, I will let you have more pictures!</p> <p>GPS 30°15'50.4"S 25°16'25.2"E⁵</p>



⁵ Click here: <https://www.google.com/maps/place/30%C2%B015'50.4%22S+25%C2%B016'25.2%22E/@-30.26399,25.2731076,163m/data=!3m2!1e3!4b1!4m13!1m6!3m5!1s0x1e85c3670262f1bd:0xabf9c39afad9fe1!2sKardoesie!8m2!3d-30.2632958!4d25.2734799!3m5!1s0x0:0x0!7e2!8m2!3d-30.2639899!4d25.2736555>

C. Farm purchases

Summary:

Philippolis district	Date	Farm
Farm purchase	1912	Geluk
Farm purchase (Leonardus Bohnen Junior)	1914	Tuinplaats
Farm purchase	1914	Smaldeel
Farm purchase	1914	Middenpost
Farm purchase Leonardus Bohnen Junior)	1912	Annex Geluk
Farm purchase	1914	Annex Eben
Farm purchase		Annex Middenpost
Farm purchase	1918	Vechtkop

6. Farm "Geluk" and "Annex Geluk"

Farm	Date	Transactions	Directions
Geluk	1912	Bohnen purchased the farm in 1912 from Willem Bulterman, and sold it three years later, in 1915, to Hester Potgieter	Geluk is about 12 km from Philippolis on the road to Luckhoff.
Annex Geluk	1915	The brothers Bulterman sold the farm to Bohnen in 1912, and he sold it to Hester Potgieter in 1915	

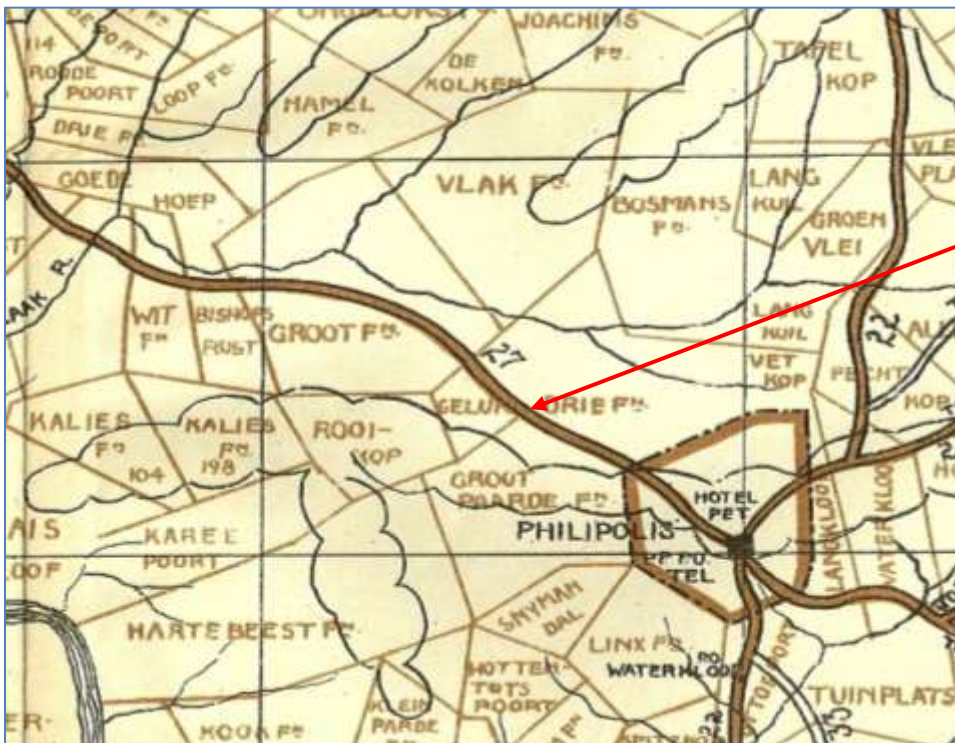

Geluk

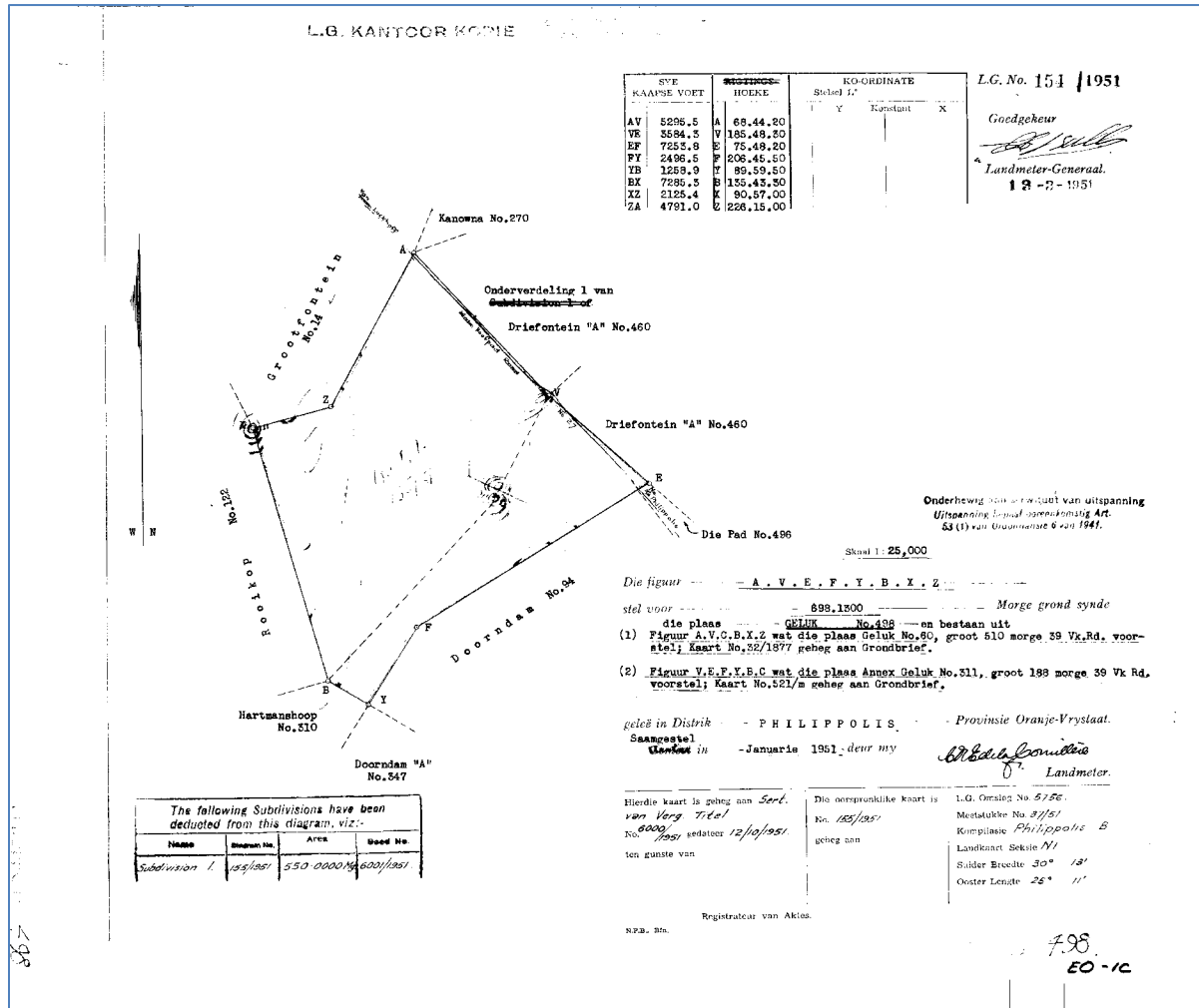

Annex Geluk:

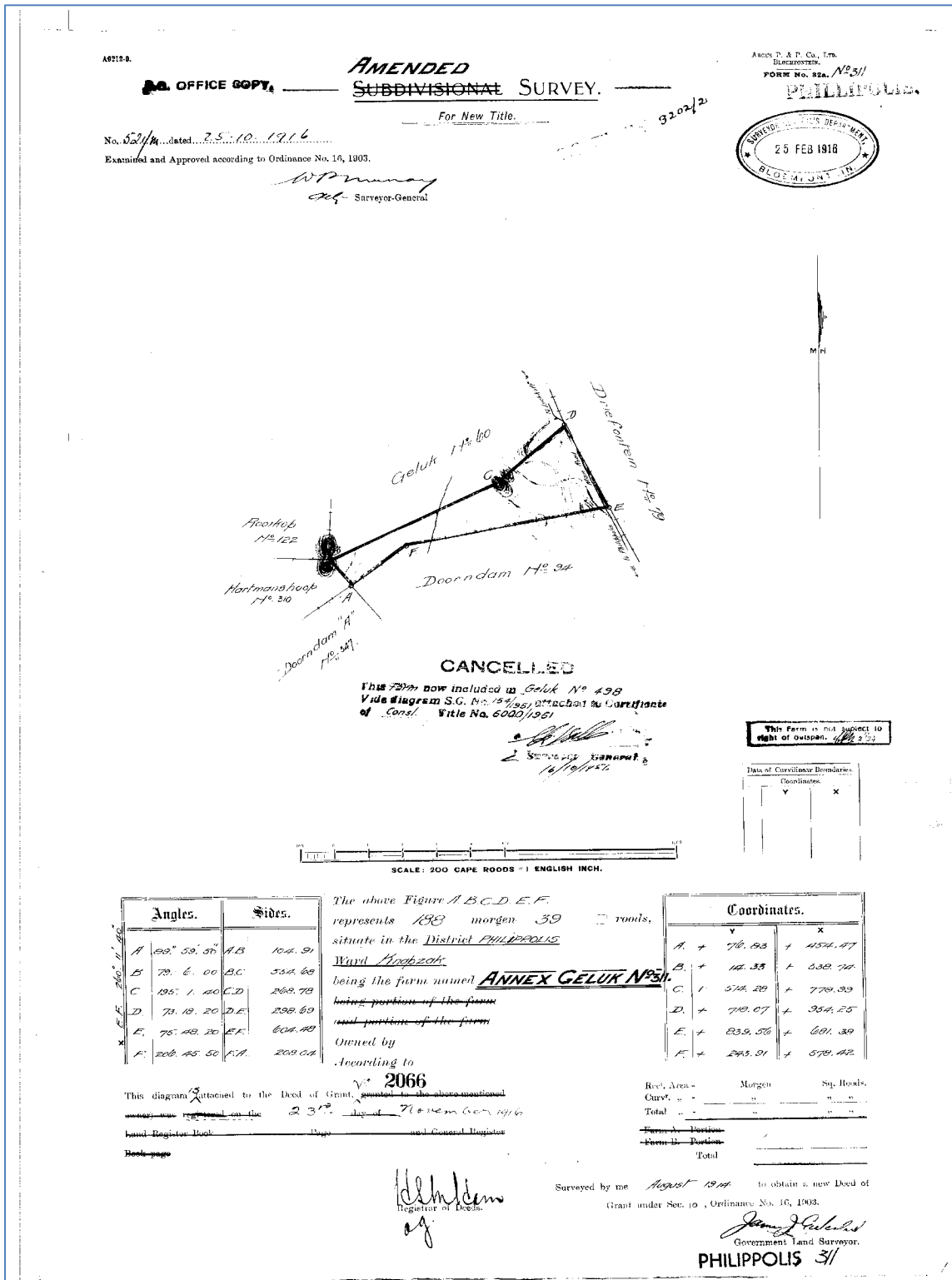

Surveyor-General's Copy

Form No. 25. SUBDIVISIONAL SURVEY FOR TRANSFER

S.G. No. F. 219/22

Examⁿ. No. 672/23

SIDES.	ANGLES.	CO-ORDINATES.	
		Y.	X.
D ₆ -D ₆ 580.86	D ₆ 57° 10' 30"	D ₆ - 295.94	+ 1810.65
D ₆ -D ₆ 330.04	D ₆ 168° 34' 50"	D ₆ + 193.96	+ 2,115.66
D ₆ -L 236.77	D ₆ 57° 14' 50"	D ₆ + 308.35	+ 2337.50
L-A 378.00	L 233° 39' 30"	L + 458.69	+ 3065.70
A-D ₇ 414.32	A 80° 34' 00"	A + 705.37	+ 1122.85
D ₇ -D ₆ 725.37	D ₇ 122° 46' 20"	D ₇ + 358.14	+ 1502.64
	From point A	A + 709.46	+ 1722.16

SCALE
1 INCH = 200 CAPE RODS

The above figure ————— D₆, D₆, D₇, L, A, D₇, D₆ ————— represents
 ————— 600 Morgen ————— O Square Rods of land being portion known as
GELUK N° 420 being portion of the farm Blaauwboschhoek N° 155.
 situate in the DISTRICT of Philippolis. ————— Orange Free State
 Surveyed in February 1923. ————— by me.

L. J. H. J. van der Merwe
 Government Land Surveyor.

Examined and Approved <u>26/4/23.</u> <u>Chas. M. Chiege</u> Surveyor-General. O.F.S. Bloemfontein. Section GA. 11: 11	This diagram is annexed to Deed of Transfer No. <u>214/1923</u> dated <u>18. 6. 23</u> <u>18. 6. 23.</u> Registrar of Deeds, O.F.S. Bloemfontein. Deale Bros., Ltd., Bloemfontein. 1000/213.	S.G. File No. <u>153.</u> EN-21 PHILIPPOLIS 420
--	---	---

7. Farm "Tuinplaats"

Date	Transactions	Directions
1914	Leonardus Bohnen Junior purchased the farm from Gideon Pyper in 1914, and sold it to Cornelis Ferreira in 1981	Tuinplaats is a beautiful farm on the Appeldoorn road. From Philippolis, drive south in the Waterkloof direction. Before you reach Waterkloof, turn left on the Appeldoorn road.

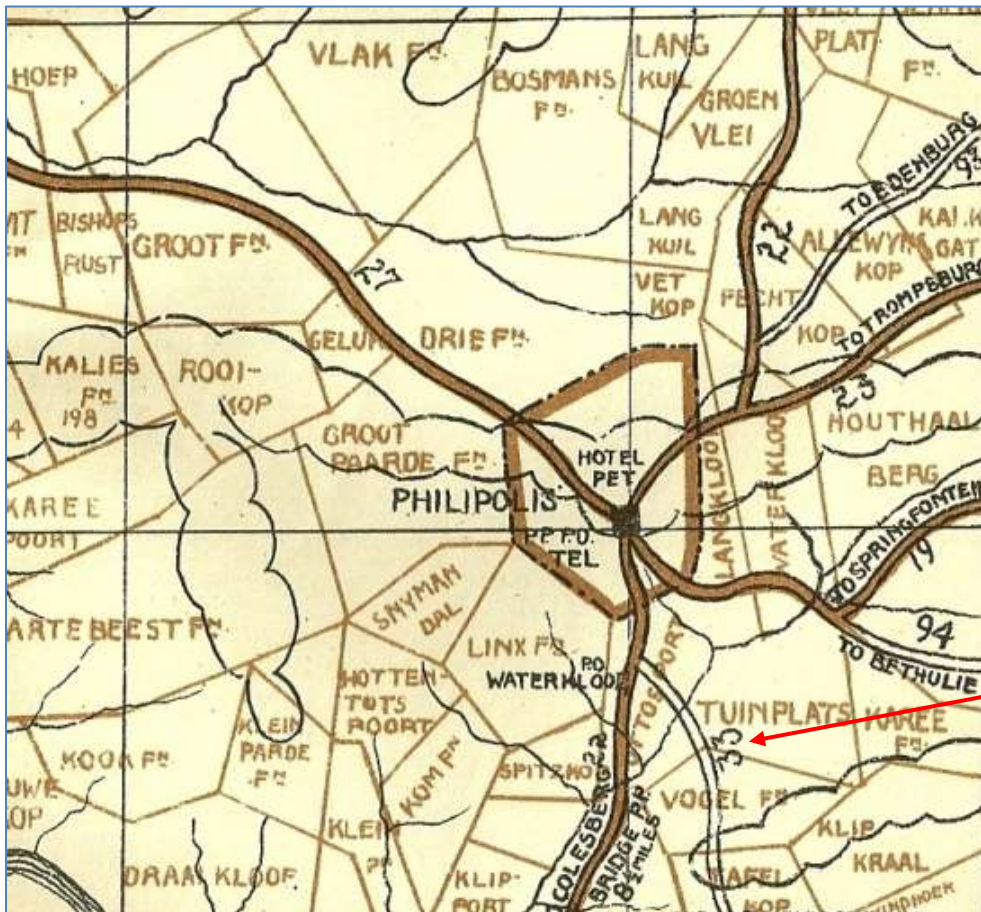

Tuinplaats

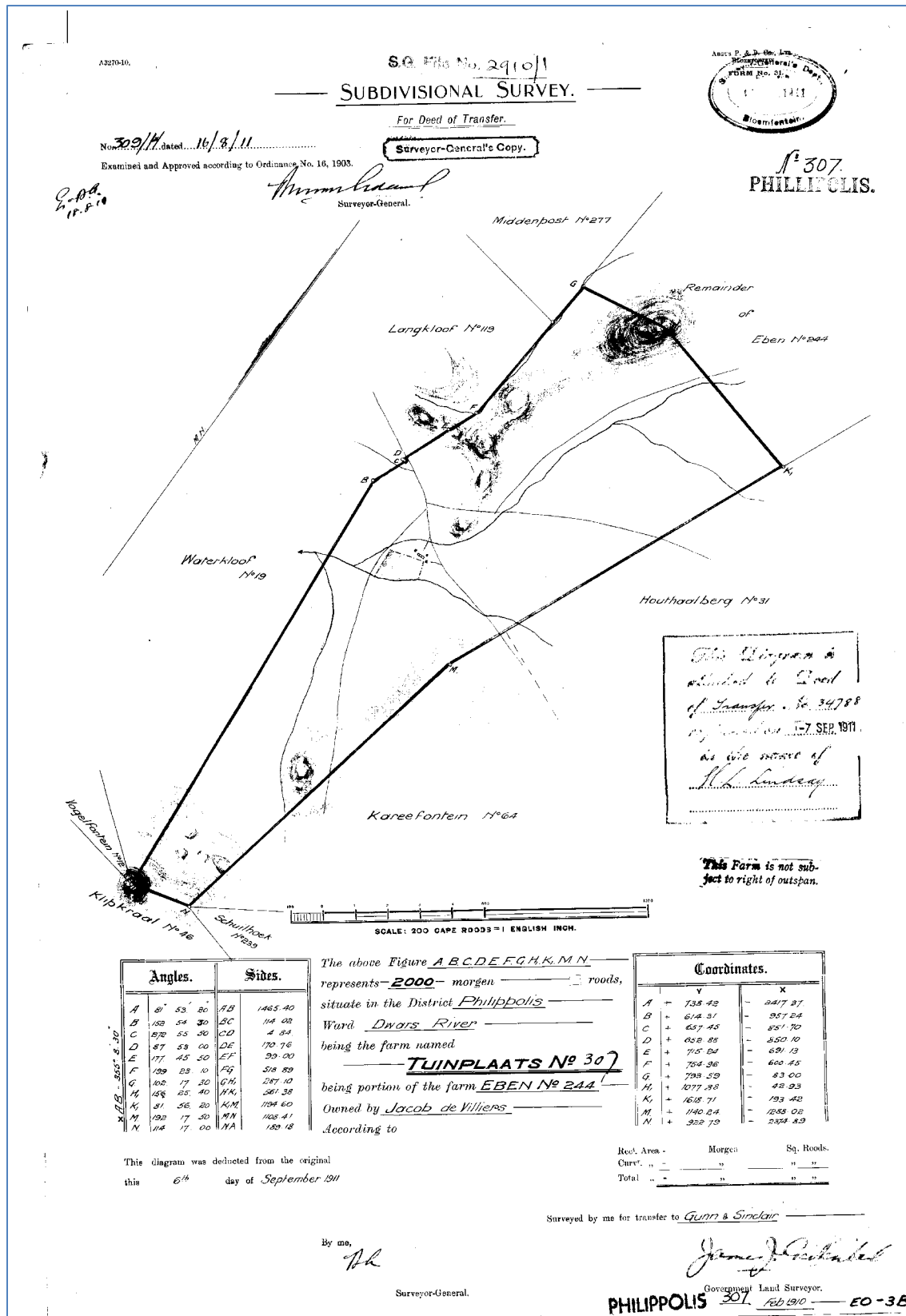

8. Farm "Smaldeel"

Date	Transactions	Directions
1914	Leonardus Bohnen purchased the property from Gideon Pyper in 1914, and sold it to George Wentworth in 1918	About 5km from Philippolis, between the Trompsburg and Springfontein roads. I don't think that these farms still exist

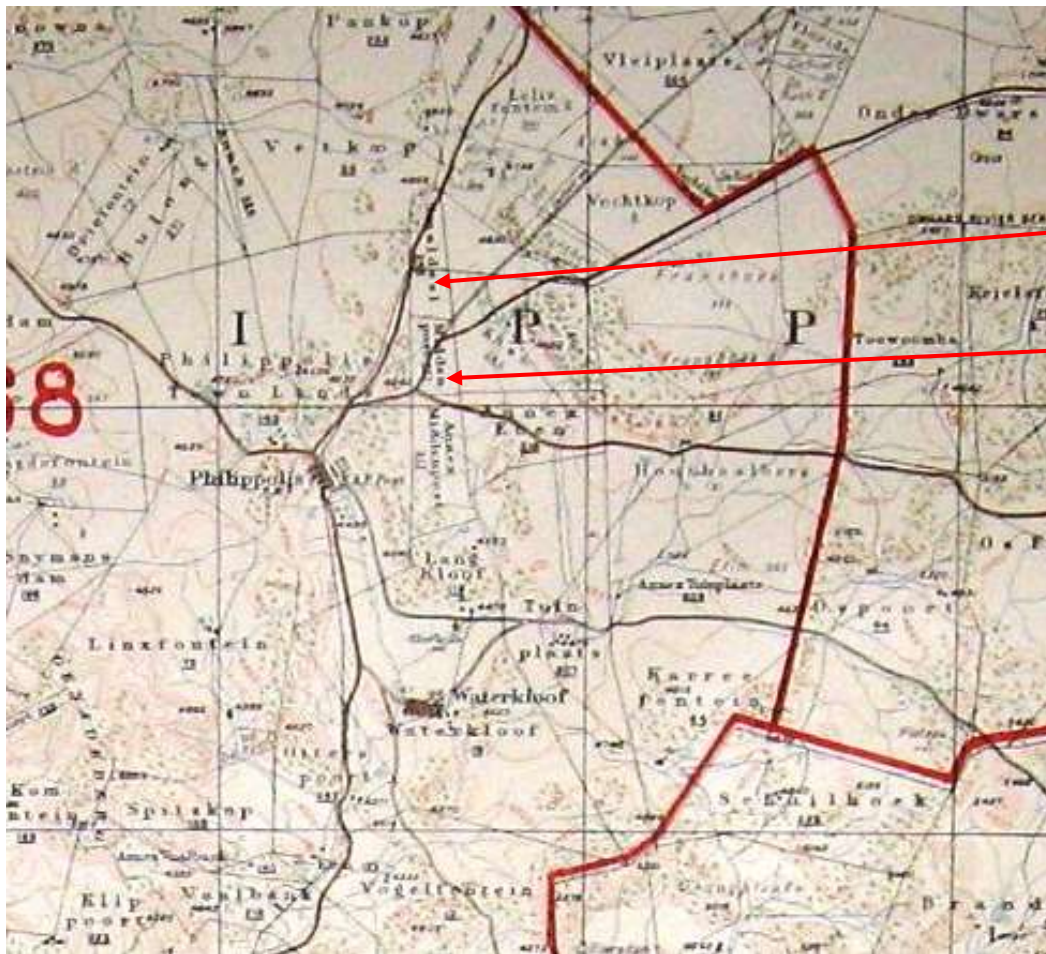

Smaldeel

Middenpost

2412

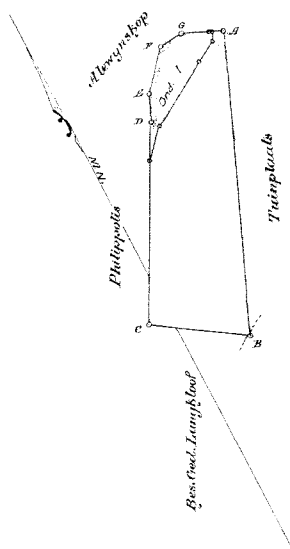

[Signature]
SURVEYOR-GENERAL

De plaats is niet anders dan
een rug van uitspanning $\frac{1}{2}$ is $\frac{1}{2}$

MOEKEN.		ZIDEN.	
A	82. 10. 20	IB	74 0 00
B	78. 57. 10	BC	247. 65
C	96. 7. 40	CD	188. 66
D	181. 52. 30	DE	69. 98
E	165. 27. 50	EF	116. 47
F	136. 27. 50	FG	61. 47
G	128. 59. 40	GH	101. 37



Bovenstaande Figuur..... A tot G..... beteekent

..... 2 4 5 Morgen..... 0 *Vuadrat Roeden gronds.*

gelegen in de Wijk. *Dwars Rivier* District *Phillipolis*

zijnde de plaats genaamd Smaldeel N^o 245
(Ged Langkloof N^o 119).

Eigenaar.....

Gremeten.....Augustus.....1892.

Gemeten door mij,

Adolph

(Gouvernements Landmeter.

CO-ORDINATES.		
<i>A</i>	- 76.17	- 1600.53
<i>B</i>	- 240.27	- 863.37
<i>C</i>	+ 000	- 889.17
<i>D</i>	+ 000	- 777.83
<i>E</i>	+ 2.29	- 7427.77
<i>F</i>	- 23.24	- 1561.41
<i>G</i>	- 74.32	- 1595.91

EO-1D

PHILIPPOLIS 245

9. Farm "Middenpost" and "Annex Middenpost"

Farm	Date	Transactions	Directions
Middenpost	1914	Leonardus Bohnen purchased the farm from Gideon Pyper in 1914, and sold it in 1918 to George Wentworth	Between the Springfontein and Trompsburg roads, about 3 km from Philippolis
Annex Middenpost	1913	Bohnen purchased from Gideon Pyper; and sold it in 1918 to George Wentworth	Ditto

A4038-11.

2912/1

SUBDIVISIONAL SURVEY.

For Deed of Transfer.

L.G. No. 2913/1912

No. 2914/11/4/12

Examined and Approved according to Ordinance No. 16, 1903.

Cx. 6974/

Surveyor-General.

FORM No. 21.

PHILIPPOLIS.

Nº 317

PHILIPPOLIS.

This Diagram is attached to Deed of Transfer Nº 317/13 registered on 7/1/1913 in the name of W. de Villiers

32.11

This Farm is subject to right of outspan over 15 morgen.

Angles.		Sides.	
T	95° 5' 20"	T.K	587.18
K	195° 13' 50"	K.P	150.00
P	83° 59' 10"	P.Q	418.28
Q	71° 50' 40"	Q.D	381.82
D	183° 58' 10"	D.T	448.25
T	89° 48' 50"	T.T	276.44

The above Figure T. K. P. Q. D. T. represents 415 morgen 584 roads, situate in the District PHILIPPOLIS Ward Dwars River being the farm named ANNEX MIDDENPOST Nº 317 being portion of the farm Middenpost Nº 277 Owned by J. D. de Villiers According to

Coordinates.	
Y	X
T	643.50 - 607.45
K	836.33 - 1162.07
P	846.64 - 1311.72
Q	1258.62 - 1239.40
D	1078.72 - 902.62
T	895.39 - 493.57
P	846.64 - 1311.80

This diagram was deducted from the original this day of

By me, **DEDUCTED** Surveyor-General.

Surveyed by me for transfer to W. de Villiers (J.D. son)

James J. Petrusdahl
Permanent Land Surveyor
PHILIPPOLIS 317
November 1911

- 38

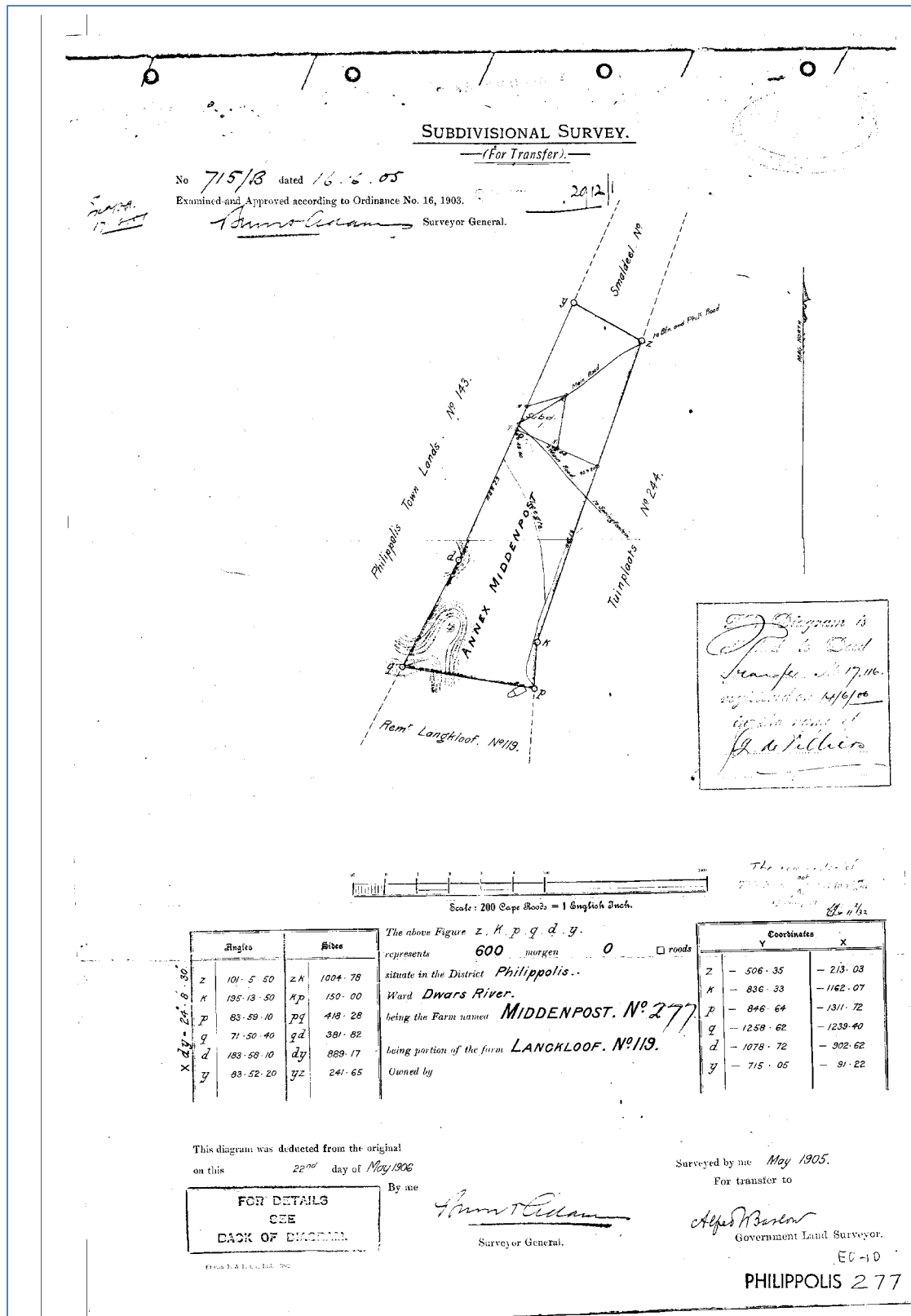

10. Farm "Annex Eben"

Date	Transactions	Directions
1914	Leonardus Bohnen purchased the farm from Gideon Pyper. He sold it in 1918 to George Wentworth	About 10 km from Philippolis on the Springfontein road – due east of Philippolis



Annex Eben

100, 800 to 29/10/11

SUBDIVISIONAL SURVEY.
For Deed of Transfer.

L.G. No. 29/2/1912
No. 937/H dated 26/3/12
Examined and Approved according to Ordinances No. 16, 1903.

[Signature]
Surveyor-General.

ANNO P. & F. CO. LTD.
BLOEMFONTEIN
26/3/1913

This Diagram is
attached to Deed
of Transfer No. 35/13
registered on 9/1/1913
in the name of
W. L. de Villiers.

N-3/6
PHILIPPOLIS.

CANCELLED
This copy was submitted 26/3/1913
vide diagram, of No. 29/2/1912, attached to
Certificate of Deed, No. 29/2/1912
[Signature]
SURVEYOR-GENERAL

SCALE: 500 CAPE ROADS = 1 ENGLISH INCH.

This Farm is not sub-
ject to right of outspan.

Angles.		Sides.	
G	62° 34' 00"	G.T.	587.18
T	84° 50' 40"	T.L.	843.40
L	90° 57' 20"	L.K.	342.24
K	98° 3' 40"	K.H.	561.38
H	203° 34' 20"	H.G.	287.10

The above Figure G.T.L.K.H. represents 585 morgen 326 roads, situate in the District PHILIPPOLIS Ward Dwars River being the farm named ANNEX EBEN N° 316 being portion of the farm Eben N° 244 Owned by J.D. de Villiers According to

Coordinates.	
Y	X
G	+ 793.59 - 83.00
T	+ 988.73 + 470.80
L	+ 1755.80 + 120.16
K	+ 1618.71 - 193.42
H	+ 1077.88 - 42.93

This diagram was deduced from the original
this day of

By me, [Signature]
14/11/1913
Surveyor-General.

Surveyed by me for transfer to W.L. de Villiers (J.D. son)
[Signature]
Government Land Surveyor.
PHILIPPOLIS 316, November 1911. **EO-38**

11. *“Vechtkop”*

Date	Transactions	Directions
1918	Leonardus Bohnen Junior was the first owner of the farm. He sold it in the same year to Cornelis Ferreira.	About 5 km from Philipopolis on the Fauresmith road (due north of Philippolis)

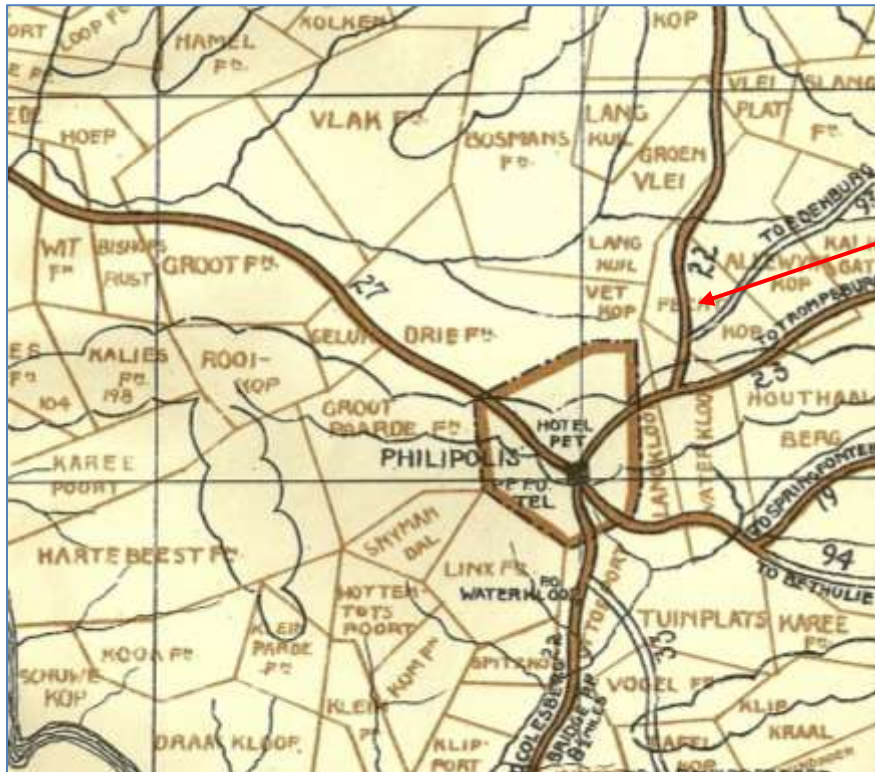

Vechtkop:

A. & P. & F. Co., Ltd.
BLANKETTED
FORM No. 21

SUBDIVISIONAL SURVEY.

For Deed of Transfer. *No. 2166/18*

NS 1513/18
313 N/ dated *27.5.18*

Examined and Approved according to Ordinance No. 16, 1900.

[Signature]
Surveyor-General.

27.5.18

[Circular Stamp]

CANCELLED

This *Plan* now included in *Plan 334*
Vide diagram G. No. *1221/2003* attached to
Certificate of Condot. Title No. *14356/2003*

[Signature]
SURVEYOR-GENERAL.

This form is not valid
by order of Surveyor-General

Coordinates.	
Y	X

SCALE: 200 CAPE ROODS = 1 ENGLISH INCH.

Angles.		Sides.	
J	56° 54' 30"	JK	429.00
K	131° 10' 30"	KL	624.84
L	77° 42' 40"	LA	163.60
A	120° 59' 20"	AB	473.17
B	143° 06' 0"	BA	462.79

The above Figure joining ridge A.L.A.B.U.
represents 400 morgen 0 ☐ roods,
situate in the District Philippolis.
Ward Omars River
being the farm named
Vechthop C. N° 381
being portion of the farm *Eben N° 244*
Owned by
According to

Coordinates.	
Y	X
J + 1635.16	+ 1075.59
K + 1809.22	+ 730.43
L + 1755.80	+ 120.16
A + 1607.01	+ 188.18
B + 1473.244	+ 642.045

This diagram was deducted from the original
this day of

Rect. Area. 389 Morgen 200 Sq. Roods.
Curve " 10 " 400 " "
Total " 400 " 0 " "

By me, *[Signature]*
Surveyor-General.

Surveyed by me for transfer to *C. J. Ferreira*
[Signature]
Government Land Surveyor.
PHILIPPOLIS 381 March 1918
EO-1D

DRAFTED
19 JUN 1918
487/1918

C. Waterkloof village (5 km south of Philippolis)

Leonardus Bohnen Jnr owned two sites in Waterkloof, but we have not found a map of the streets of Waterkloof yet. We therefore cannot geo-locate the properties yet. Philippolis is a ghost town today, with only one elderly resident.

Location	Date of first purchase	First owner	Dates of later transactions	Later transactions
Onder, Boshoff and Townlands Streets	1921	Leonardus Bohnen Jnr	1921	Bohnen sold to Daniel Benjamin Janse v Rensburg
			1962	Sold to Jan Johannes Christoffel Kruger born 1914
			1963	Sold to Marius Alet? Abel??? Venter born 1932
			1969	Sold to Stephanus Hermanus Jacobs born 1920
			1981	Estate late Jacobs sold to Andre Jacobs born 1952
Onder and townlands streets	1921	Leonardus Bohnen Jnr	1921	Bohnen sold to Daniel Benjamin Janse v Rensburg
			1962	Sold to Jan Johannes Christoffel Kruger born 1914
			1963	Sold to Marius Alet? Abel??? Venter born 1932
			1969	Sold to Stephanus Hermanus Jacobs born 1920
			1981	Estate late Jacobs to Andre Jacobs born 1952



Waterkloof today – a ghost town



D. Bohnens serving the NG Church in Philippolis

The NG Church was established in Philippolis in 1861, after the mass exodus of Griqua people to Kokstad. However, many coloured people remained in Philippolis, and it was necessary for the NG Church to undertake mission work amongst them. After Rev Fraser became the clergyman in 1863, he also managed this task. He was assisted by the American missionary, W Torglan Corner. Due to the parlous financial state of the Church, Corner was hardly ever paid a stipend.

Corner died in 1876, and this meant that a new missionary had to be found. But after deliberations, the NG Church decided to give this task to the “koster” (beadle/clerk). But they found that the existing *koster*, J Erskine, was not qualified sufficiently for this task. The Church Council then appointed Mr Bohnen for a year, at the salary of 90 pounds per annum. He kept this post until 1882.

Under his leadership, the mission work proceeded so well that a missionary church was built in 1878. The building could seat 300 people, and was located in Burger Street (on the east side of the Otterspoort River). The church was inaugurated on 2 November 1878, and many people from nearby congregations attended. The membership grew, until it had about 90-100 members.

Bohnen retired as beadle in 1882, and then a full-time evangelist was appointed.

Bohnen had also served as beadle of the main NG Church, from roughly 1878 (date not clear), until he resigned in 1882.

After the war, L Bohnen was appointed as a paid scribe/cashier. (This may have been the younger Mr Bohnen, i.e. son of Leonardus Bohnen). He filled this post for four years.⁶

E. Marriage certificate

I have the following certificate available:

⁶ Information drawn from JA Bosch, *Eufoesgedenkboek van die NG Gemeente Philippolis 1862-1962*, 1962, pp 86-87, and 109-110. A copy of this scarce book is available from Collector's Treasury, at https://www.abebooks.com/servlet/SearchResults?sts=t&cm_sp=SearchF--home--Results&an=bosch&tn=philippolis&kn=&isbn=

ORIGINEEL REGISTER.

1901 Huwelyk bevestigd te *Philippolis* in de Parochie van *Philippolis* in het District van *Philippolis* 1897

No.	Waarvoor getrouwd.	Namen en Tussennamen.	Ouder- den.	Soort.	Uitg. of Betrop.	Waarom niet op het Huwelyk.	Na huwelyk ge- ten of niet Licentie.	Tuissending, hier niet gegeven of op order van den Regier.
92	18 July 1897	Leonardus Bohnen.	28	Leugen	Uitloos	Klein Lenteke Philippolis - geboden.	Na huwelyk geheten.	ster Anders
		Susanna Francina. Verspreid	28	hage geboden				

Getrouwd in de Parochie der N. L. G. te *Philippolis* voornacht van *huwelykgeboden*, door my

De Huwelyk is
voltrokken tus-
schen ons.....

L. Bohnen
S. f. g. geboden

In de tegenwoordigheid van

H. S. L. de Boer
J. J. K. K. K. K.

(I have included a bigger copy in the Addendum file).

F. Bohnens in the concentration camps 1900-1902⁷

Curiously, the Bohnens were interned in two concentration camps – Bethulie and Norvalspont.

1. Bethulie (and later Uitenhage)

Mrs **Cecilia Jacoba Bohnen** was 26 years old when she arrived at the Bethulie camp, in midwinter, on 14 June 1901. Her husband, Leonardus, was on commando.

She was accompanied by her two children: **Leonardus Jacobus**, who was 5 or 6 years old when he arrived at Bethulie camp; and **Cecilia Jacoba**, who was a year old at arrival.

⁷ Drawn from BCCD database (<https://www2.lib.uct.ac.za/mss/bccd/>) and other sources.

Little Leonardus died of inflammation on 22 September 1901. He apparently died in the hospital at the camp. Two months later, Cecilia died on 28 November 1901, of pneumonia. She was then 1 year and three months old.

On 27 April 1902, Mrs Bohnen was transferred to the Uitenhage camp. By then, she was 27 years old.

The BCCD data-base also refers to an “EM Bohnen” (gender unspecified), who was in the camp at Bethulie. It is not clear how she was related to Mrs Cecilia Bohnen.

2. Norvalspont

Four Bohnens were interned at Norvalspont.

They were Master Francois J Bohnen, age 8; Mr Hendrik TE Bohnen, age 22; Mr Leonard Bohnen, age 60; and Mrs Susanna Franzina Bohnen, age 50. Old Mr Bohnen was listed as a “baker and butcher”.

All of them arrived on 28 November 1900, although the information for Mrs Susanna Bohnen was left blank, so we can’t be sure.

Susanna died on 1 February 1901, of dysentery.

After peace was declared, Francois and Hendrik left the camp on 23 July 1902, and old Mr Bohnen only left on 20 August 1902. This meant that he lived in the camp for a total of 21 months. He apparently never signed the oath of neutrality.

G. The Bohnens’ economic life after the war

In Braby’s *Orange Free State Directory* of 1907⁸, L Bohnen is recorded as being a general merchant. I would surmise that this referred to Mr Bohnen senior, but I can’t be sure.

In the 1908 Braby, H Bohnen is listed as a general merchant.⁹ Is this a misprint?

In 1909, there are two entries: “Bohnen, L, senior, gentleman”, and “Bohnen L, senior, general dealer”.¹⁰ Why two listings? Are these the same person?

⁸ Page 601.

⁹ Page 702.

¹⁰ Page 815.

The 1909 Braby lists “L Bohnen, Junior”, as a baker.¹¹

The 1910 Braby lists “L Bohnen, junior” as the secretary of the Hospital, and “Mr L Bohnen senior” as the caretaker.¹² Bohnen Junior is still listed as a baker, as well as a butcher. This also applied in the 1911-1913 Braby’s.

By 1914, a “Bohnen, L senior, gentleman” was still listed¹³, but there was no mention of Bohnen Junior in the town. He was not listed amongst the farmers either.

At this stage, I do not have copies later than 1914, but I should get some in due course, and will take another look.

¹¹ Page 817.

¹² Page 877.

¹³ Page 817

Appendix: Title Deeds Data

TOWN SITES:

1. The Philippolis Hotel:

Erf numbers	Dates of purchase	First owner	Dates	Transactions
32, 33, 34 (Hotel)	1886	Leonardus Bohnen ¹⁴	1893	Charles Edmondson
	1886		1904	Sold to Max Blumenthal
	1886		1912	Sold to Mallett and Leggett
	1886		1912	Sold to FEW Leggett
	1886		1921	Sold to Salomon Lipsker
	1886		1926	Sold to Borkowf (as above)
	1886		1939	Sold to Fock (as above)
	1886		1945	Sold to Jacobus Johannes Grobler (as above)
	1886		1947	Sold to "Barnard seuns"
	1886		1948	Sold to Harry Muller Segal
	1886		1952	Sold to Etienne Bruwer, born 1918 (as above)
	1886		1979	From Bruwer's estate to JJR Jacobs, von 1942 and SH Jacobs, born 1955 - as above
	1886		1983	Sold to Christjan Jacobs, born 1947, as above
	1886		1984	Sold to Cornelius Jansen v Rensburg, born 1938, as above

2. The Du Toits' home and Labomat Engineering site

187, 188, 189	1886	Carl Christiaan Mathey	1898	M to Govt ORC
			1898	Sold to Leonardus Bohnen
			1903	Sold to Philippus Wilhelmus Gerhardus Snyman
			1906	Sold to Martha Elizabeth Snyman
			1916	Sold to Catharina Elizabeth Snyman
			1919	Sold to Philip Jacobus Malherbe

¹⁴ This is the first owner that appears in the data at the Deeds Office. It is possible that someone else (or LB himself) "owned" or used the site before 1886, but that it was not

			1923	Sold to Izak Abraham Johannes Malherbe
			1949	Sold to Johannes Jacobus Rabie vd Linde born 1893
			1969	Estate late van der Linde sold to David Frederik Jacobs born 1915, Pieter Daniel Jacobus Cilliers born 1920, Jacoba Johanna Greyvenstein, and Abrahama Paulina van Ryneveld
			1969	Sold to Frederick Johannes v Ryneveld, born 1921

3. Malherbe Plein and Municipal Library

10	1886	Govt OFS	1904	From Govt to Leonardus Bohnen
			1915	Sold to Gideon Francois Pyper
			1915	Sold to Johan George Hartman
			1919	Sold to Gideon Francois Pyper
			1925	Sold to Nicolaas Andries van Schalkwyk
			1926	Sold to Hendrik Jacobus Eloff
			1927	Sold to Petrus Jacobus Hattingh
			1947	Sold to Petrus Johannes Botes
			1965	Sold to Jan Lodewikus Vorster, born 1918
			1977	Sold to Blanca Kundra Alida Malherbe, born Reitz, born 1931
			1979	Sold to Municipality Philippolis
11		Christoffel Albertus J van Rensburg	1890	Sold to Otto Carl Heinrich Krause
			1903	Sold to Leonardus Bohnen
			1915	Sold to Johan George Pyper
			1915	Sold to Gideon Francois Hartman
			1925	Sold to Nicolaas Andries v Schalkwyk
			1926	Sold to Hendrik Jacobus Eloff
			1927	Sold to Petrus Jacobus Hattingh
			1947	Sold to Petrus Johannes Botes
			1965	Sold to Jan Lodewikus Vorster, born 1918
			1977	Sold to Blanca Kundra Alida Malherbe, born Reitz, born 1931
			1979	Sold to Municipality Philippolis
12		Sarel Johannes Liebenberg	1888	Sold to Andreas Tobias Kolver
			1888	Sold to Jemima Cornelia Visser
			1904	Sold to Leonardus Bohnen

			1915	Sold to Gideon Francois Pyper
			1915	Sold to Johan George Hartman
			1920	Sold to Gideon Francois Pyper
			1921	Sold to Leah Jacobson
			1977	Sold to: Rosalind Heller Jacobson, born 1917, Naomi Fletcher, born Jacobson, born 1926; Leslie Jacobson, born 1919; Julius Jacobson, 1921; Jacob Jacobson, 1932, in equal shares.
			1972	Sold to Municipality Philippolis
			1978	Sold to Govt of RSA

4. Erf 170:

Erf numbers	Dates of purchase	First owner	Dates	Transactions
170	1886	Leonardus Bohnen	1906	Bohnen to Gerrit Jan Cornelis Sem
			1907	Sold to Jacobus Johannes Boshoff
			1920	Sold to Gideon Francois Pyper
			1921	Sold to Sarel Jacob du Plessis
			1936	Sold to Isabella Maria Pienaar
			1977	Estate late Pienaar sold to Leoni Dempers gebore Pienaar, 1919, widow

FARMS:

5. Geluk:

Farm	Folio	First date	First owner	Later dates	Later owners
Geluk (Portion Grootfontein no 14)	60	1879	Henry Harvey	1879	Harvey to Jan Hendrik Boshof
				1880	B to Hendrik Boshof
				1895	B to Firm Sem and Bulterman
				1906	Firm to Johannes Bulterman
				1908	B to Willem Hendrik Bulterman and Johannes Bulterman

				1912	Half: WH Bulterman to Johannes Bulterman
				1912	Whole: Bulterman to Leonardus Bohnen
				1915	B to Hester Maria Heyns born Potgieter
				1926	H to Gerhardus Wilhelm Jacobs Pienaar
				1927	P to Hendrika Gertruida Abrama van der Linde
				1929	VdL to Daniel Jacobus Johannes Swanepoel Jnr
				1945	DJJ Swanepoel and DPP Swanepoel to Johannes Hendrik Boshoff born 1883
					United with Farm Annex Geluk no 311 in consolidated farm Geluk no 498

6. Annex Geluk:

Farm	Folio	First date	First owner	Later dates	Later owners
Annex Geluk (Portion Doorndam 94)	311	1912	J Bulterman and WH Bulterman	1912	Joint owners to Leonardus Bohnen Jnr
				1915	B Jnr to Hester Maria Heyns born Potgieter
				1926	H to Gerhardus Wilhelm Jacobs Pienaar
				1927	P to Hendrika Gertruida Abrama van der Linde born Ehlers widow
				1929	vdL to Daniel Jacobus Johannes Swanepoel born 1931
				1945	Swanepoel and Swanepoel to Johannes Hendrik Boshoff born 1883
					United with farm Geluk no 60 in consolidated farm Geluk no 498

7. Tuinplaats:

Farm	Folio	First date	First owner	Later dates	Later owners
Tuinplaats (portion of Waterkloof no 219) (changes to	244		Estate late A.M Hockly	1885	estate late A.M Hockly to Jacob Daniel Villiers

Eden no 244 on 31/8/1911)					
				1911	Title deed to Jacob Daniel de Villiers
					Split into Tuinplaats no 307, Annex Eben no 316 and remainder
					Tuinplaats no 307
				1911	J.D de Villiers sold to Henry Lill Lindsay
					Annex Eben no 316
				1913	Estate late J.D de Villiers sold to Willem Louw de Villiers
					Remainder
				1913	Estate late J.D de Villiers sold to Willem Louw de Villiers
				1913	W.L de Villiers sold to Gideon Francois Pyper
				1914	G.F Pyper to Leonardus Bohnen Junior
					Split into Vechtkop no 381 and remainder
					Vechtkop no 381
				1918	L. Bohnen Junior sold to Cornelis Johannes Ferreira
					Remainder
				1918	L. Bohnen Junior sold to George Will Murray Bulterman
				1919	Sold to Solomon Philip Rothbart
				1928	Estate late Rothbart sold to Sarah Fanny Rothbart (born Jacobson) widowed
				1928	Estate late Rothbart sold to Jacobson Bros (half) and John Jacobson (half)
					Split into half, quarter and remainder
				1937	<i>Half:</i> Joint estate late Bernhard Davis, Herberg and surviving spouse Cecilia Herberg (born Jacobson)widowed, Moritz Jacobson
				1937	<i>Quarter:</i> Estate late B.D Herberg sold to Cecilia Herberg (born Jacobson)widowed
				1937	Deed of partition to Moritz Jacobson (half), Cecilia Herberg (born Jacobson)widowed (half)
				1937	Title issued to Moritz Jacobson
				1953	Deed of partition to Cecilia Herberg (born Jacobson in 1892)
				1979	Herberg sold to Pieter Daniel Jacobs (born 1936)

8. Smaldeel:

Farm	Folio	First date	First owner	Later dates	Later owners
Smaldeel (portion of Langkloof no 199)	245	1894	C.H Boshoff	1894	C.H Boshoff sold to Jacob Daniel de Villiers
				1913	Sold o Willem Louw de Villiers
				1913	Sold to Gideon Francois Pyper
				1914	G.F Pyper sold to Leonardus Bohnen
				1918	Bohnen sold to George Will Murray Wentworth
				1918	Sold to Willem Hendrik Bulterman
				1919	Sold to Solomon Philip Rothbart
				1928	Sold to Jacobson Brothers (half) and John Jacobson (half)
				1934	Sold to Maritz Jacobson (quarter), joint est late Bernhard Davis, Herberg and surviving spouse Cecilia Herberg (born Jacobson)widowed
				1937	Sold to Cecilia Herberg (born Jacobson)
				1937	Deed of partition to Moritz Jacobson (half), Cecilia Herberg (born Jacobson)widowed (half)
				1937	Registered title to Moritz Jacobson
				1953	Deed of partition: Cecilia Herberg (born Jacobson in 1892)
					Subdivision 1:
				1954	Herberg sold to Eric Herberg (born 1918)
				1979	Sold to Pieter Daniel Jacobs (born 1936)

9. Middenpost:

Farm	Folio	First date	First owner	Later dates	Later owners
Middenpost	277	1906	CH Boshof	1906	Bosholf sold to Jacob Daniel de Villiers
				1913	Divided into Annex Middenpost 617 and Remainder
					Middenpost
				1913	De Villiers sold to Willem Louw de Villiers
					Remainder
				1913	De Villiers sold to Willem Louw de Villiers
				1913	Sold to Gideon Francois Pyper
				1914	Pyper sold o Leonardus Bohnen

				1918	Bohnen sold to George Will Murray Wentworth
				1918	Sold to willem Hendrik Bulterman
				1919	Sold to Solomon Philip Rothbart
				1928	Sold to Sarah Fanny Rothbart
				1930??	Sold to Jacobson Brothers and John Jacobson
				1929	<i>Half:</i> Jacobson Bros sold to Moritz Jacobson and Joint estate Berhard David Herberg and Surviving spouse Cecilia Herberg
				1937	<i>Quarter:</i> Jacobson Bros sold to Cecilia Herberg born Jacobson
				1937	Whole: Deed of Partition: Moritz Jacobson and Cecilia Herberg (born Jacobson, widow)
				1937	<i>Half:</i> Registered title: Moritz Jacobson
				1939	Divided into Ond 1 and Remainder
					Ond 1
				1949	DM Jacobson and Herberg sold to John Roderick and Co Ltd
				1969	Sold to Petrus Jacobus Wiese born 1935
				1969	Sold to Cornelius Petrus Grobbelaar born 1909
				1979	Estate late Grobbelaar sold to Elsie Margaretha Simes born Grobbelaar born 1940
					Remainder
				1953	Deed of Partition: Cecilia Herberg, born Jacobson 1892
				1979	Sold to Pieter Daniel Jacobs born 1936

10. Annex Eben

Farm	Folio	First date	First owner	Later dates	Later owners
Annex Eben (Portion Eben no 244)	316	1913	Estate late JD de Villiers	1913	De Villiers sold to Willem Louw de Villiers
				1913	Sold to Gideon Francois Pyper
				1914	Pyper sold to Leonardus Bohnen Jnr
				1918	Bohnen sold to George Will Murray Wentworth
				1922	Sold to Elsie Josephine Wentworth born du Plessis widow
				1925	Sold to Pieter Carel Grobbelaar
				1941	Sold to Pieter Grobbelaar born 1905
				1951	Sold o Gabriel Jacobus Marais born 1910

				1951	Sold to Rufus vd Merwe born 1907
				1960	Sold to Cornelius Petrus Grobbelaar born 1909
				1979	Estate late Grobbelaar sold to Elsie Margaretha Simes born Grobbelaar 1940

11. Vechtkop

Farm	Folio	First date	First owner	Later dates	Later owners
Vechtkop C (Portion Eden no 244)	381	1918	L Bohnen Jnr	1918	Bohnen sold to Cornelis Johannes Ferreira
				1919	Sold to Solomon Philip Rothbart
				1928	Estate late Rothbart to Sarah Fanny Rothbart born Jacobson widow
				1928	Sold to Jacobson Bros, John Jacobson halves
				1937	Half: Jacobson sold to Moritz Jacobson and Joint Estate late Bernhard David Herberg and surv spouse Cecilia Herberg born Jacobson widow (quarters)
				1937	Quarter: Estate late DB Herberg sold to Cecilia Herberg born Jacobson widow
				1937	Whole: Deed of Partition: Moritz Jacobson and Cecilia Herberg born Jacobson, halves
				1937	Registered title: Moritz Jacobson
				1953	Deed of Partition: Cecilia Herberg born 1892
				1979	Herberg sold to Pieter Daniel Jacobs born 1936